

Plat of Survey

of

Lot 57 of Oak Knolls of Walworth Addition No. 1,

a subdivision located in the Southeast 1/4 of Section 22, Town 1 North,
Range 16 East, Village of Walworth, Walworth County, Wisconsin.

Surveyed for: **The Rauland Agency, Inc.**

118 Kenosha Street
Walworth, Wisconsin. 53184



Bearings reference to the plat of Oak
Knolls of Walworth Addition No. 1.

William Street
(66' Wide)

Arc=65.05'
Radius=275.61', Chord=N41°38'06"E 64.90'
(N41°38'06"E 64.90')

Lot 58

S55°13'14"E 112.62'
105.30'
(205.27')
10' Setback line as shown on the plat

Lot 59

**House
No. 918**

**Lot 57
Tax Parcel
VOK1 00030**
0.206 Acre
8,994 Sq.Ft.

N41°43'29"W
(N41°42'17"W 120.00')

S37°04'16"W 92.53'
(S36°59'34"W 92.53')

Outlot 1

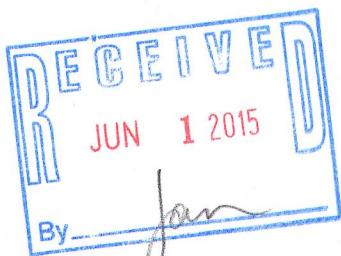

Lot 56

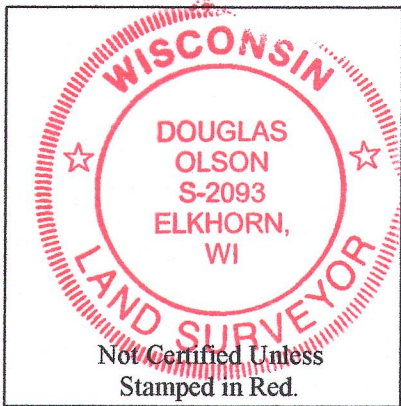

Copyright 2014 by Jensen & Olson Land Surveying, LLC.

All rights reserved. No part of this survey plat may be reproduced or transmitted in any form by any means - graphic, electronic, or mechanical, including photocopying, tracing, or information storage and retrieval systems - without permission in writing from Douglas G. Olson, Jensen & Olson Land Surveying, LLC.

I hereby certify that I have surveyed the above described property and the map hereon is correct to the best of my professional knowledge and belief and shows the size and location of the property, its exterior boundaries, the location and dimensions of all visible structures thereon, boundary fences, apparent easements and roadways and visible encroachments, if any.

This survey is made for the exclusive use of the present owners of the property, and also those who purchase, mortgage or guarantee title thereto, within one year from the date hereof.

Douglas G. Olson
Wisconsin Registered Land Surveyor - 2093

Notes:

- 1) This survey plat is not certified unless signed and sealed in red ink.
- 2) This survey is subject to Wisconsin lien laws. This Plat of Survey is the notice of intent to file lien. Lien waiver required.

Legend

- Found Iron Pipe
- Found Iron Rod with cap
- Recorded Information
- Utility Pedestal
- Water Valve
- Catch Basin
- Asphalt Surface
- Concrete Surface
- Manhole



Jensen & Olson Land Surveying, LLC

45 South Wisconsin Street * P.O. Box 322 * Elkhorn, Wisconsin. 53121

Telephone: (262) 723-3434 * Facsimile: (262) 723-8044

Email: jensen.olson@elknet.net

Scale: 1" = 20'



Survey date: July 14, 2014.

Revisions:

009-1217

Sheet 1 of 1 Sheets.

Job Reference Number:

2014.067

VOK1-30